

LASER-ART STRUCTURES by BRANCHLINE TRAINS

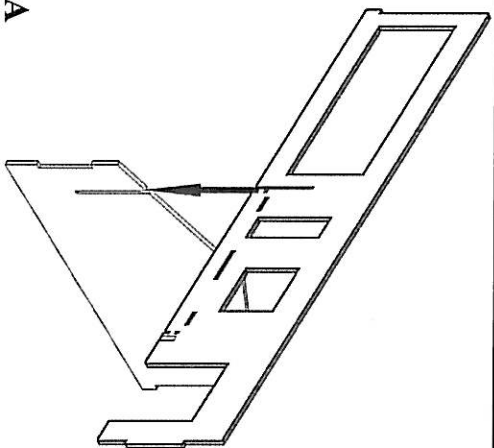

1A

Constructing the shell:

- 1A) Start construction by gluing the center support wall to the front wall as shown.
- 1B) Now glue the left end wall and the rear wall to the core section that you just assembled. Next, glue the divider wall that separates the garage from the house as shown.
- 1C) The right end wall and the front bay wall can now be glued into place.

Windows and Doors:

- 2A) To assemble the windows start by removing the peel-and-stick backing from the lower sash and applying a section of clear window glazing to it. Repeat with the upper sash and frame it being sure to keep the edge of the glazing flush with the top edge of the window. Now stick the lower sash into place on the frame. Note that it is possible to position the lower sash in an open position if desired. remove the peel-and-stick from the window frame. Center the window sash assembly into the frame and press into place.

It is best to place the various window assemblies into their openings as they are done. The peel-and-stick on the frame will be more than enough to hold them into place.

To assemble the front and garage doors, remove the peel-and-stick from the outer door panel and attach it to the inner panel. Then press the door into the frame. Now insert the completed door into the wall opening using the adhesive on the frame to hold it in place.

The rear sliding door assembles in the same manner but uses a large sheet of clear glazing instead of an inner panel.

2B) Apply the window shutters next to the front and side windows only. (The rear windows do not have shutters).

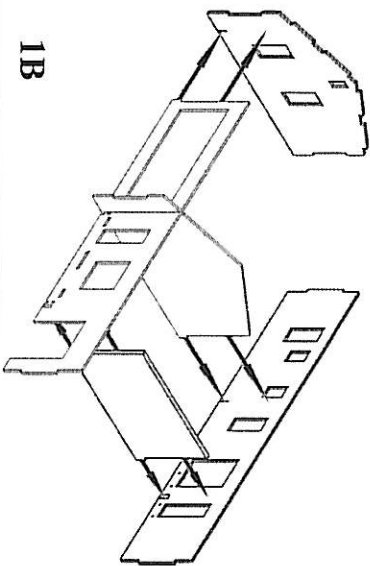

1B

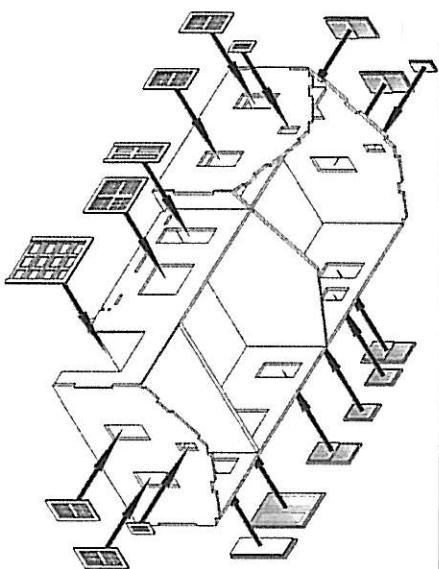
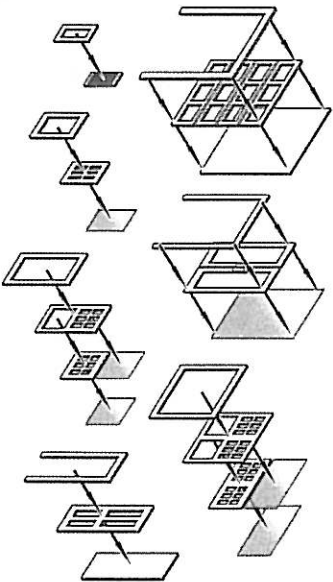

2A

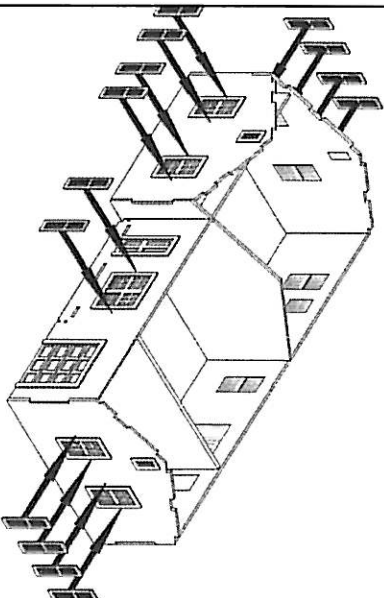

2B

**LASER-ART
STRUCTURES**